



Wennington Road, Southport PR9 7TN. England  
Tel: 01704 518000 Fax: 01704 518001  
WEB SITE <http://www.unipartdorman.co.uk>  
E MAIL address – [dorman.info@unipartdorman.co.uk](mailto:dorman.info@unipartdorman.co.uk)

#### Health and safety

Every effort has been made to ensure the accuracy of the information given in our publications, but in accordance with our policy of continually improving our products we reserve the right to modify designs and specifications whenever necessary. All equipment is designed to conform to relevant British and International standards. Every care is taken to ensure that, as far as reasonably practical, it will perform without risk to health. It is essential that accepted codes of professional practice are followed in the assembly, installation and commissioning of the equipment. If in doubt with respect to any of these instructions, please consult Dorman before installing the device.

Dorman reserves the right to vary any component part to meet the required specifications without prior notice.



Certificate No. FM 14371

Dorman ref. No C64.65499 Iss 1

---

## CLS Frame Pivot Bar E-Clip Replacement Using CLS Pivot Bar Retainer (B20.19514) Installation Instructions

---

To be read before commencing  
installation

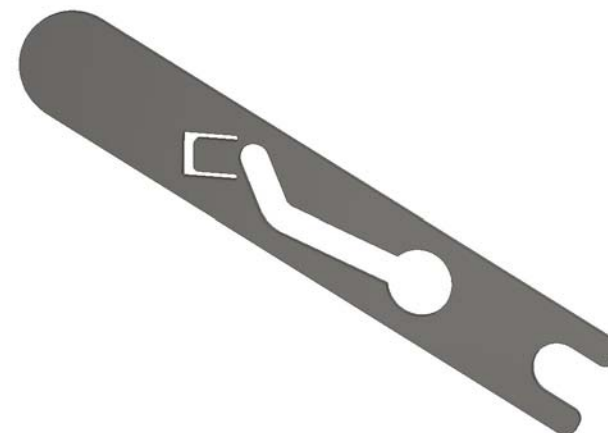

## General.

In general before commencing assembly, any local safety requirements affecting the safe working environment of the signalling installation either directly or indirectly should be carried out.

### Removal of the existing E-clip

The existing E-clip should be removed using a suitable tool (screwdriver) and disposed of safely.

The existing M5 hex head screw and shake proof washers can be loosened away from the mounting plate, they do not have to be removed completely.

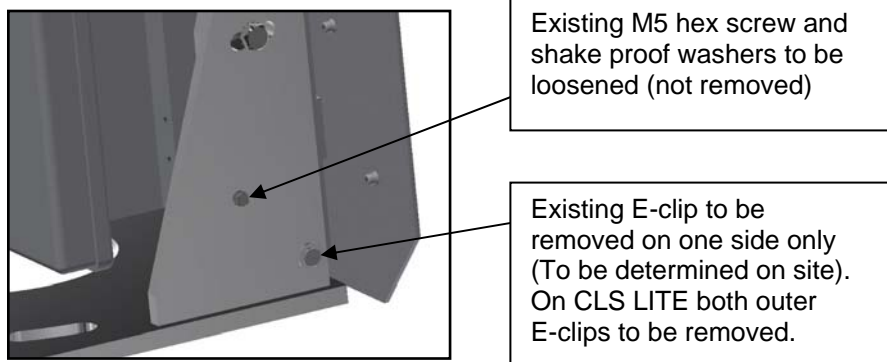

### Fitting of replacement Pivot Bar Retainer

The Pivot Bar Retainer can now be fitted by firstly locating the retainer's larger cut out over the existing bolt head and then sliding the open slot at the bottom into the groove where the original E-clip was fitted.

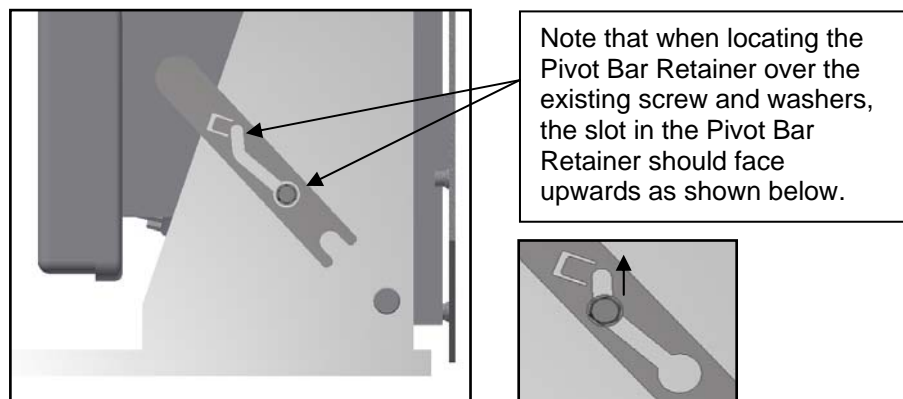

As the Pivot Bar Retainer locates into the pivot bar slot, the retainer should be assembled to the frame as shown below. The existing M5 hex head screw can now be tightened to secure the retainer bar

The M5 screw should be tightened up to a torque of 2.5Nm.

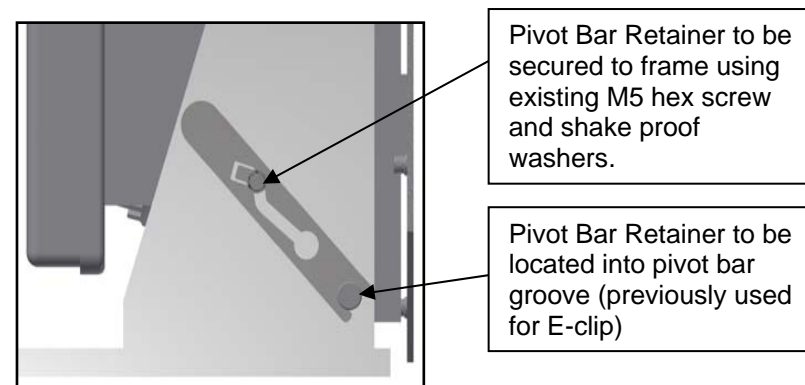
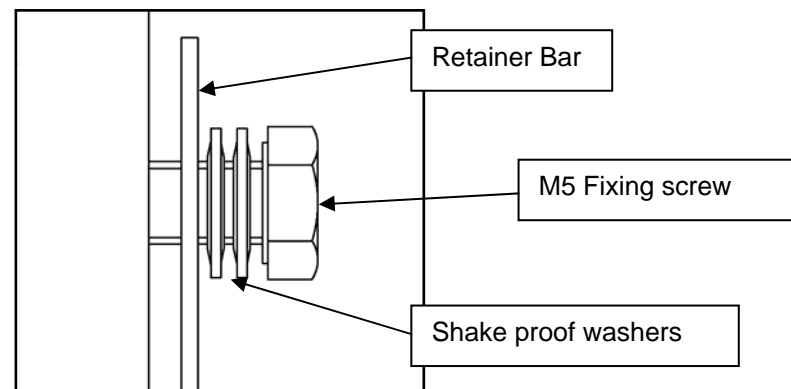

Once the retainer bar has been fitted and tightened, using a screwdriver, the locating tab on the on the Pivot Bar Retainer can be prised up to lock against the bolt head as shown in below.

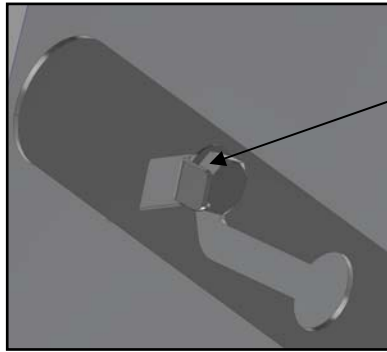

Locating tab on retainer bar prised over to lock against screw head.

#### **General information.**

The Pivot Bar Retainer can be used on all existing Classic CLS and CLS LITE Signal assemblies.

On Classic CLS frames, the Pivot Bar will only be required to be fitted to one side of the signal frame. This can be decided by the engineer on site, depending on access and ease of fitting etc.

The iLS CLS LITE assemblies will require a second Pivot Bar Retainer to be fitted so both sides of the signal mounting frame will have this component fitted.

#### **Additional Information if Earth Strap is fitted to Signal Frame**

If the designated fixing for the Retainer Bar has been utilised for assembling an earth strap, then the following procedure should be adhered to:

1. Remove all the fixings and earth strap.
2. Assemble the Retainer Bar, shake proof washers, earth strap and fixing screw as shown in below.
3. Please note it may not be possible to bend the Locating Tab on the Retainer up into the fixing screw head.

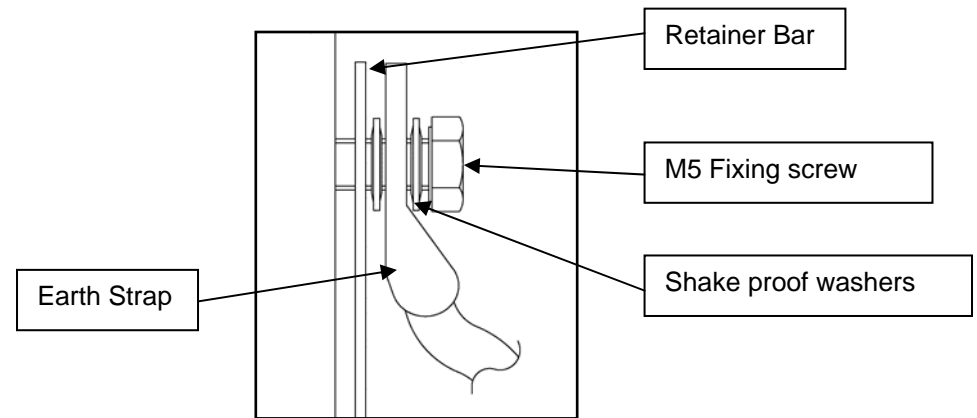

CLS Pivot Bar Retainer (Retrofit) Fitting Kit (10 Retainers):

Unipart Dorman Part Number – D86.85277

PADS Number: 0086/000045