



Performance in motion



# Fixed Train Lamps



The Unipart Dorman range of Fixed Train Lamps have been designed to be drop in replacements for existing filament lamp and reflectors.

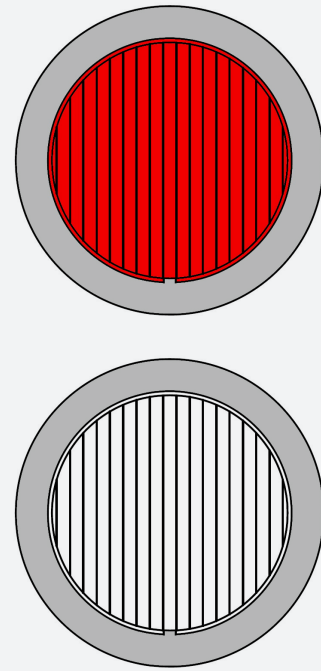

In most cases they do not require any alterations in the electrical connection. Mechanically, the use of two different flange diameters and a range of adaptor rings allow the lamp to fit all BMAC housings, Class 47 and J Stone Enclosures.

The Fixed Marker Lamp is a white lamp and the Fixed Tail Lamp is a red and both comply with the Railway Group Standard GM/RT 2131 - Audible and Visual Warning Devices fitted to new locomotives and Trains.

#### Performance Characteristics

Product Approval Certificate	24 Vdc, 74Vdc, 110Vdc
Nominal Operating Current	24 Vdc – 125mA, 74Vdc – 25mA, 110Vdc – 25mA
Electrical Connector Type	400mm of cable with either a B22d bayonet connector that fits into the existing lamp holder, an AMP Superseal connector or customer specified termination.
Ingress Protection Rating	IP 66
Operating Temperature Range	-25°C to +40°C
Light Output	100Cd on optical axis
Product Weight	1.1 Kg
For product instructions and dimensioned drawings please visit:	<a href="http://www.unipartdorman.co.uk">www.unipartdorman.co.uk</a>

## Product Configuration

145mm Flange

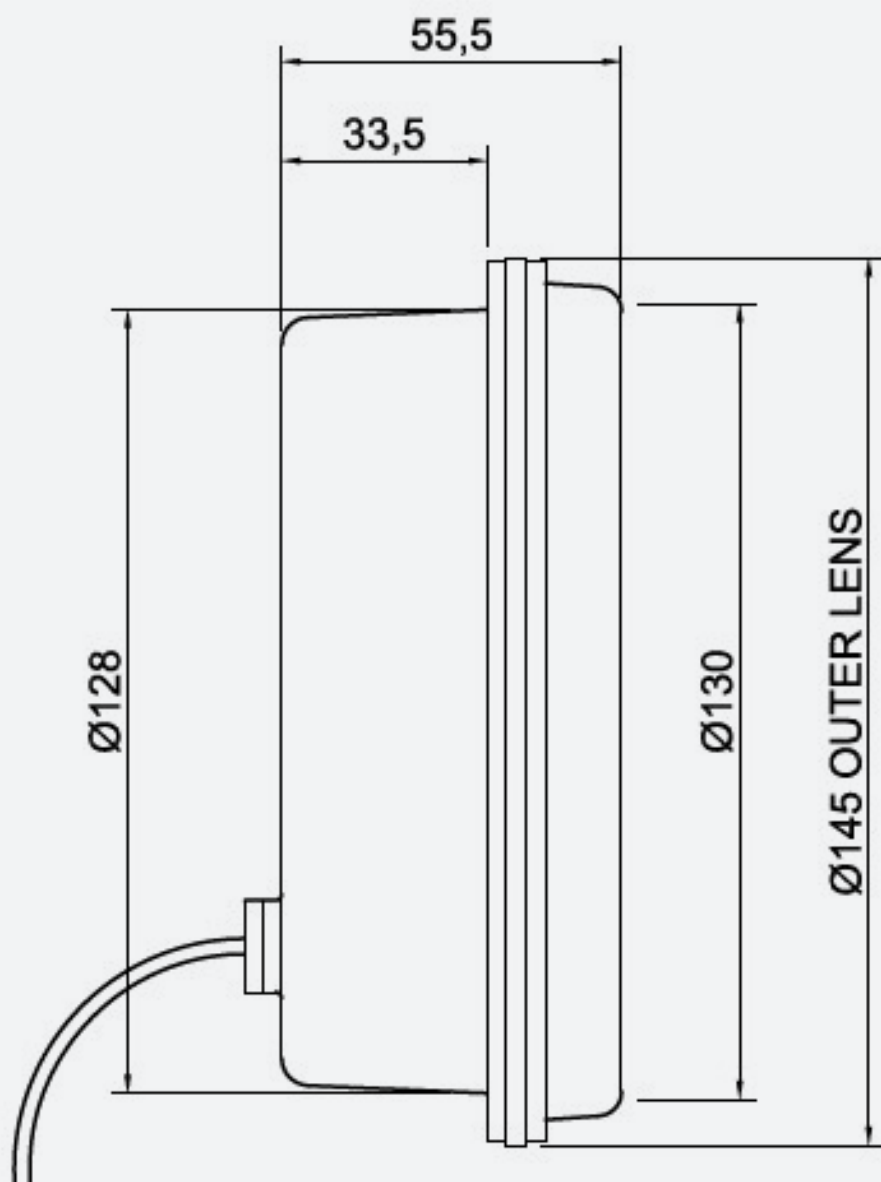

# Product Configuration

162mm Flange

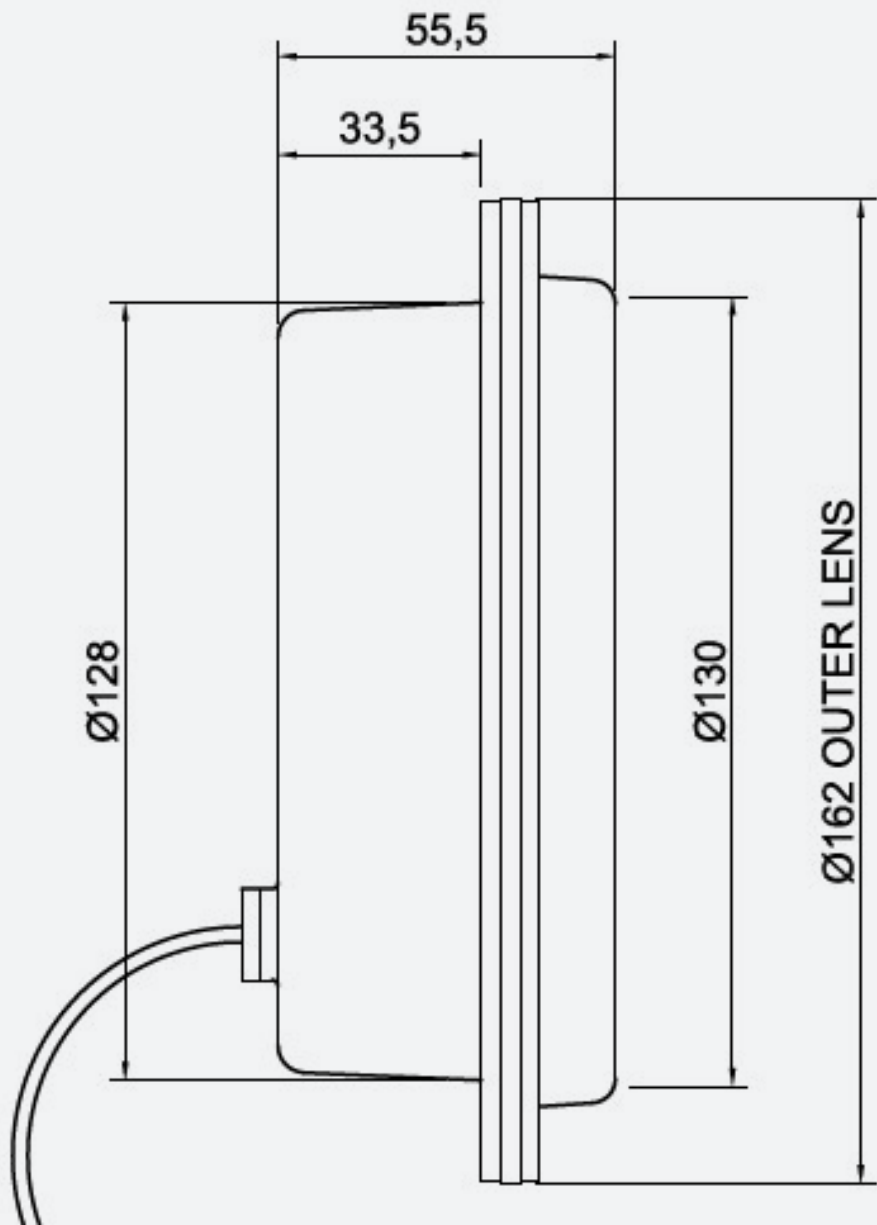

## Catalogue Numbers

### Marker Lamp

Catalogue Number	Unipart Dorman Part Number	Description
0054/040629	LFM2N/W/01/B/06	Fixed Marker Lamp, 110v, Amp Connector and User Defined Adaptor Ring
0054/040630	LFM2N/W/01/A/04	Fixed Marker Lamp, 110v, With J Stone Adaptor Ring
0054/040631	LFM2N/W/01/B/02	Fixed Marker Lamp, 110v, To Fit BMAC Double Light Unit
0054/040632	LFM2N/W/03/A/04	Fixed Marker Lamp, 74v, To Fit Irish Rail Light Unit
0090/004949	LFM2N/W/01/A/00	Fixed Marker Lamp, 110v, No Fitting Kit BMAC Single
TBC	LFM2N/W/01/B/05	Fixed Marker Lamp, 110v, To Fit Class 4 Tail Light Unit
TBC	LFM2N/W/03/A/00	Fixed Marker Lamp, 74v, To Fit BMAC Single Light Unit
TBC	LFM2N/W/01/B/03	Fixed Marker Lamp, 110v
TBC	LFM2N/W/02/A/04	Fixed Marker Lamp, 24v, With J Stone Adaptor Ring
TBC	LFM2N/W/01/A/00	Fixed Marker Lamp, 24v, No Fitting Kit

## Catalogue Numbers

### Tail Lamp

Catalogue Number	Unipart Dorman Part Number	Description
0054/040633	LFT2N/R/01/B/05	Led Fixed Tail Lamp With Class 47 Adaptor Ring
TBC	LFT2N/R/0/B/05	Led Fixed Tail Lamp With Class 47 Adaptor Ring 24V
0054/040634	LFT2N/R/01/A/04	Led Fixed Tail Lamp With J Stone Adaptor Ring
0054/040635	LFT2N/R/02/B/03	Led Fixed Tail Lamp To Fit Bmac Triple Unit
0054/040636	LFT2N/R/02/A/04	Led Fixed Tail Lamp With J Stone Adaptor Ring 24V
0054/040637	LFT2N/R/03/A/04	Led Fixed Tail Lamp With J Stone Adaptor Ring 74V
TBC	LFT2N/R/03/A/00	Led Fixed Tail Lamp 74V
0054/040638	LFT2N/R/02/A/00	Led Fixed Tail Lamp With Bmac Single Unit 24V
0054/040639	LFT2N/R/02/B/02	LED Fixed Tail Lamp, 24V To fit BMAC Double Light Unit
0098/017217	LFT2N/R/01/B/03	Fixed Tail Lamp, 110V No Fitting Kit BMAC Triple
0098/017217	LFT2N/R/01/A/00	Fixed Tail Lamp, 110V No Fitting Kit BMAC Single

# Product Configuration

## Adaptor Ring Kit

Catalogue Number	Unipart Dorman Part Number	Description
TBC	D70.69006	J Stone Adaptor Ring

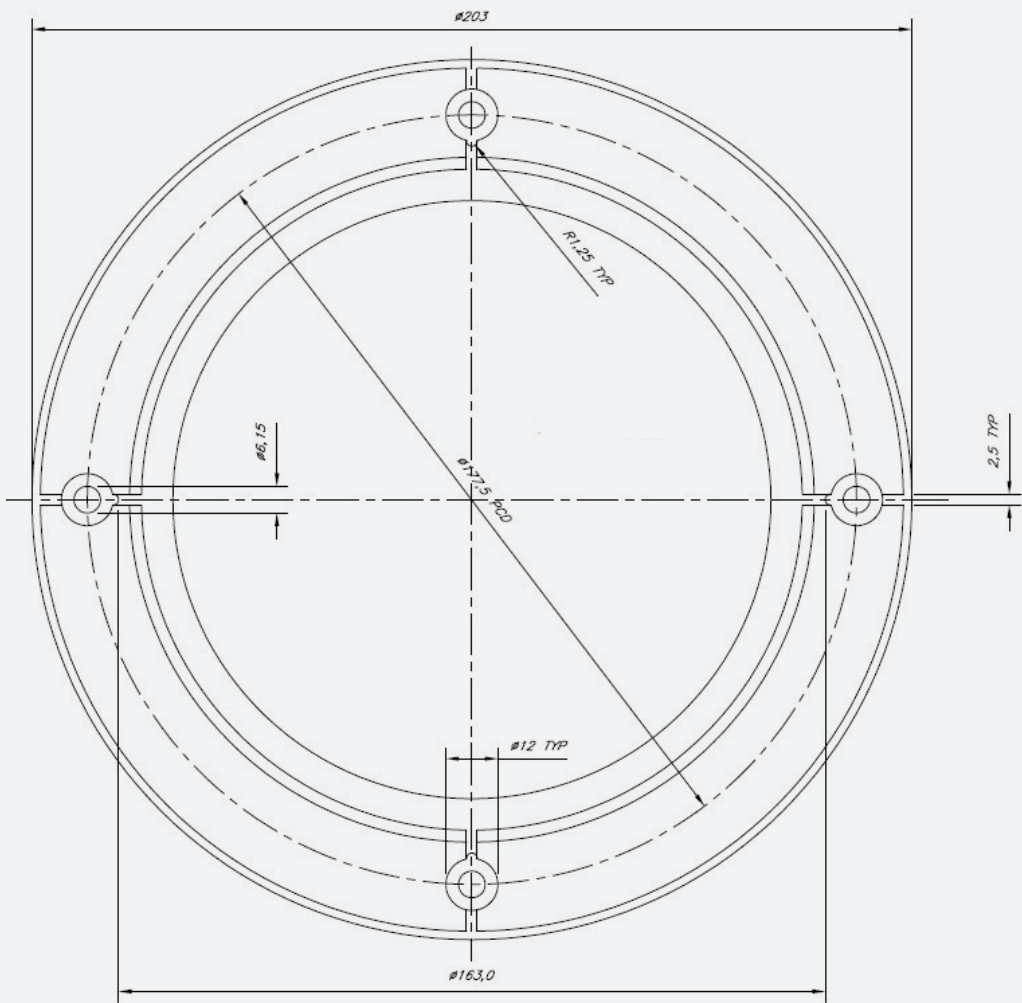

# Product Configuration

## Adaptor Ring Kit

Catalogue Number	Unipart Dorman Part Number	Description
TBC	D70.69007	BR Adaptor Ring

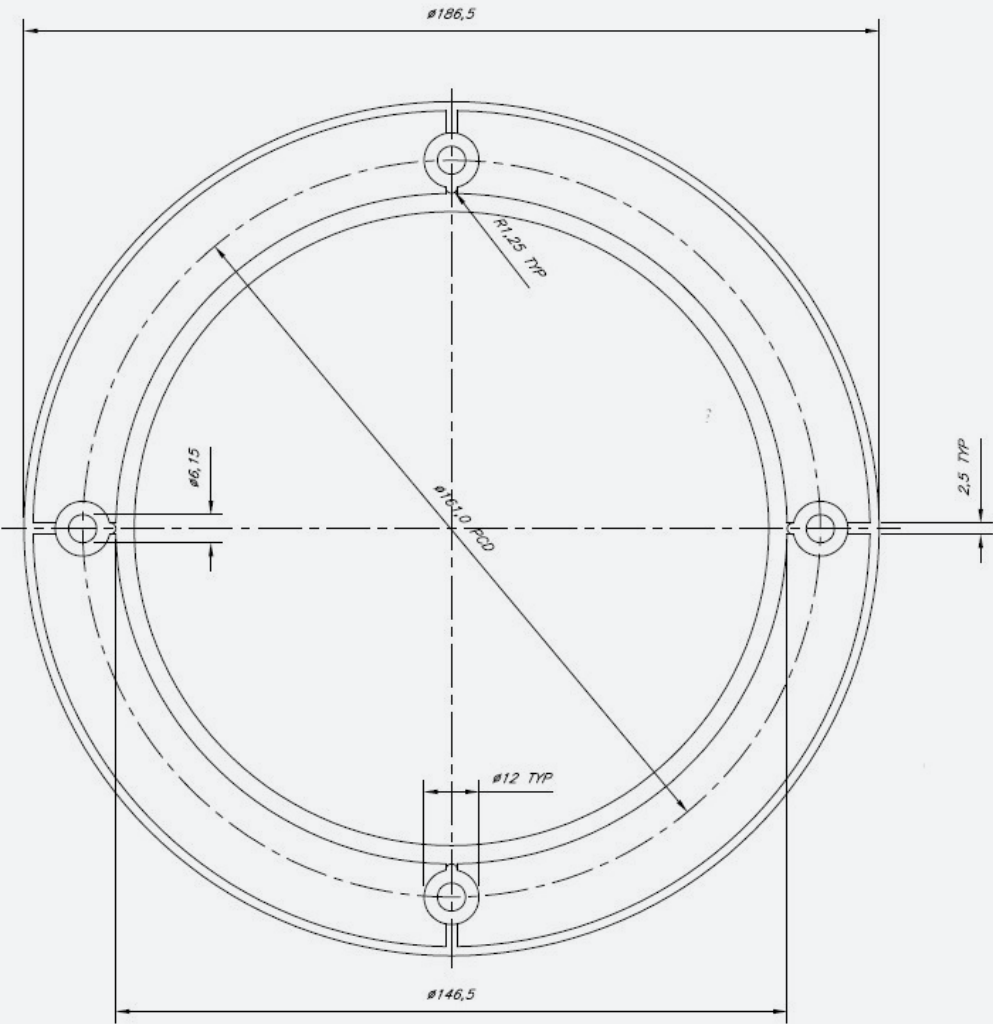

# Product Configuration

## Adaptor Ring Kit

Catalogue Number	Unipart Dorman Part Number	Description
TBC	C62.61052M001	Class 47 Adaptor Ring

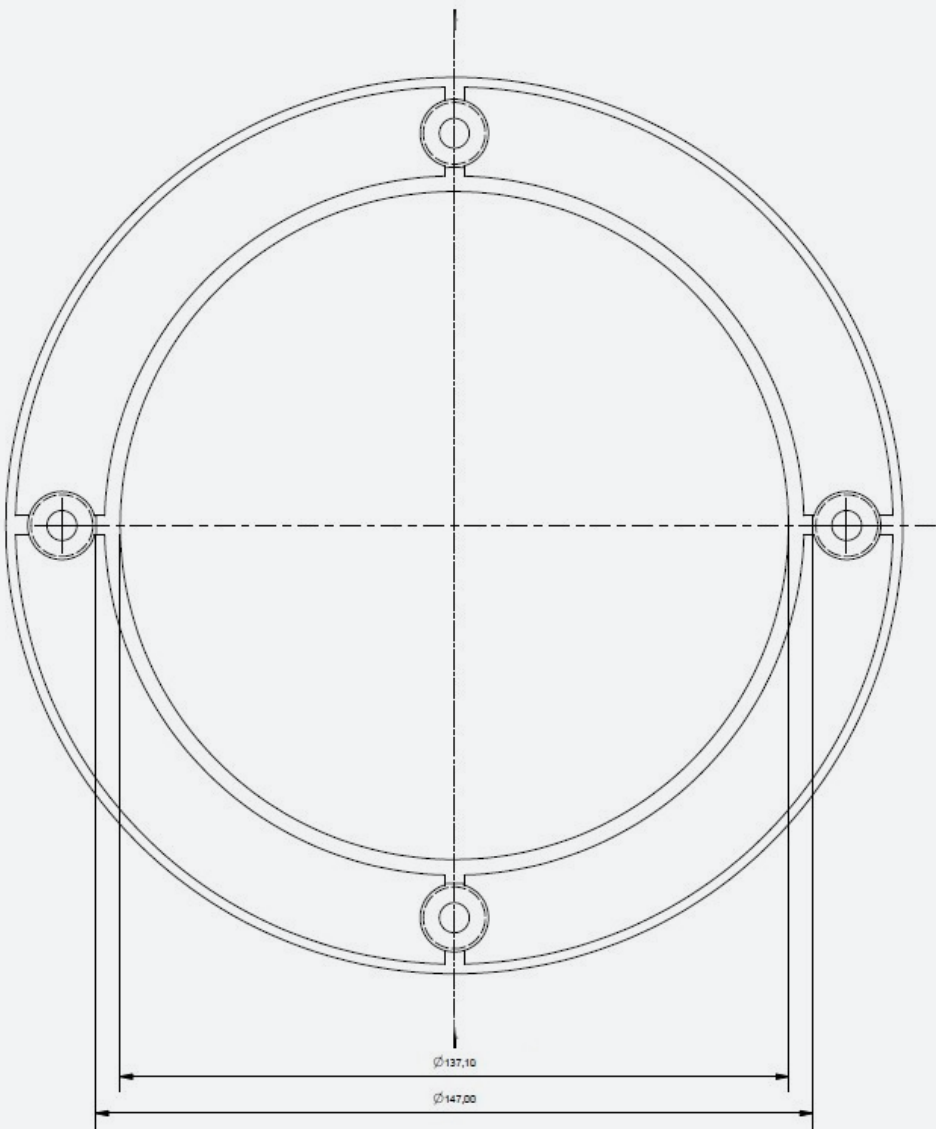

Contact us today to learn  
how we can help your  
business improve reliability,  
efficiency and safety in  
railway operations.



Click or scan  
to contact us