



Performance in motion



Miniature PoSA Signal



The Unipart Dorman Miniature Proceed on Sight Authority (PoSA) Tunnel Signal uses 2 dual colour Miniature Tunnel Modules (MTM).

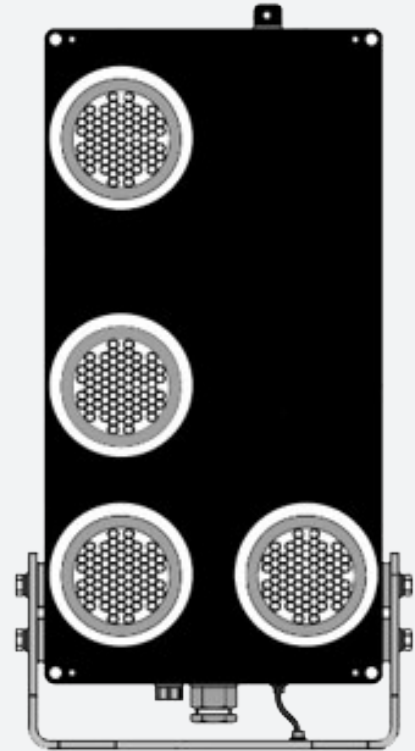

Displaying either Red/Yellow or Yellow/Green to deliver 4 aspects with the addition of two White Modules positioned at 45 degrees to give a Position Light Subsidiary or 'Call On' aspect and can be either ground, elevated or roof mounting.

Mk2 MTM are supplied for new signals and these are not interchangeable with either Mk1 MTM or standard SLM. The Product Acceptance states "In the event of a Mk1 Module requiring replacement the complete signal head shall be replaced

Performance Characteristics

Product Approval Certificate	PA05/04536
Nominal Operating Voltage	110 Vac or 120 Vdc
Operating Voltage Range AC	88-121 V
Operating Voltage Range DC	88-145 V
Nominal Operating Current	300 mA at 110Vac
Electrical Connector Type	Free Wired to 2BA Terminal Bar
Ingress Protection Rating	IP 65
Operating Temperature Range	-25°C to +40°C
Readability	400m in tunnel conditions (RYYG Aspects) 100m in Tunnel Conditions (WW Aspect)
Product Weight	Signal 20Kg Module only 1.6Kg
For product instructions and dimensioned drawings please visit:	www.unipartdorman.co.uk

Product Configuration

The Miniature PoSA is available in 3 configurations.

Ground Mounted where the Red Aspect is in the top module.

Elevated Mounted where the Red Aspect is in the bottom left module.

Roof Mounted where the Red Aspect is in the bottom right module and the modules are inverted.

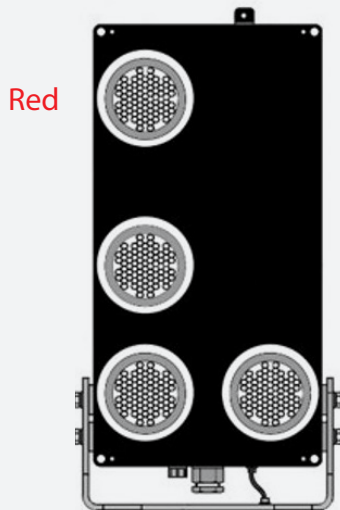

Ground

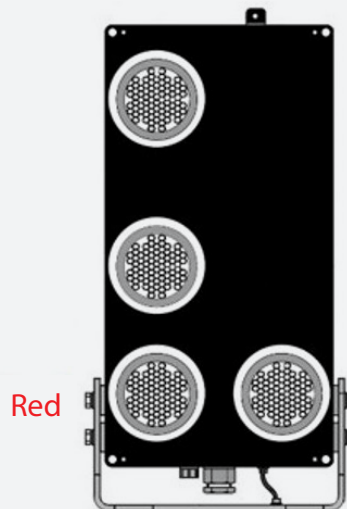

Elevated



Roof Mounted

Aspect Colours

Dual colour Miniature Tunnel Modules are used and can display Red/Yellow or Green/Yellow for the Colour Light Signal Aspects and the Subsidiary uses Lunar White MTM which will give the full range of aspects up to and including RYYGWW.

Product Configuration

Following a design improvement exercise, the Miniature Tunnel Module (MTM) was modified to move the breather from the bottom of the module to the back plate and this aligns with a orifice in the redesigned case to remove any moisture ingress to the MTM in the tunnel environment by not venting straight to atmosphere but into the void inside the case.

These modules and signals have been designated as Mk2 signals and are not interchangeable with the Mk1.

The Network Rail Product Acceptance Certificate clearly states “In the event of a Mk1 module requiring replacement, the complete signal head shall be replaced.”

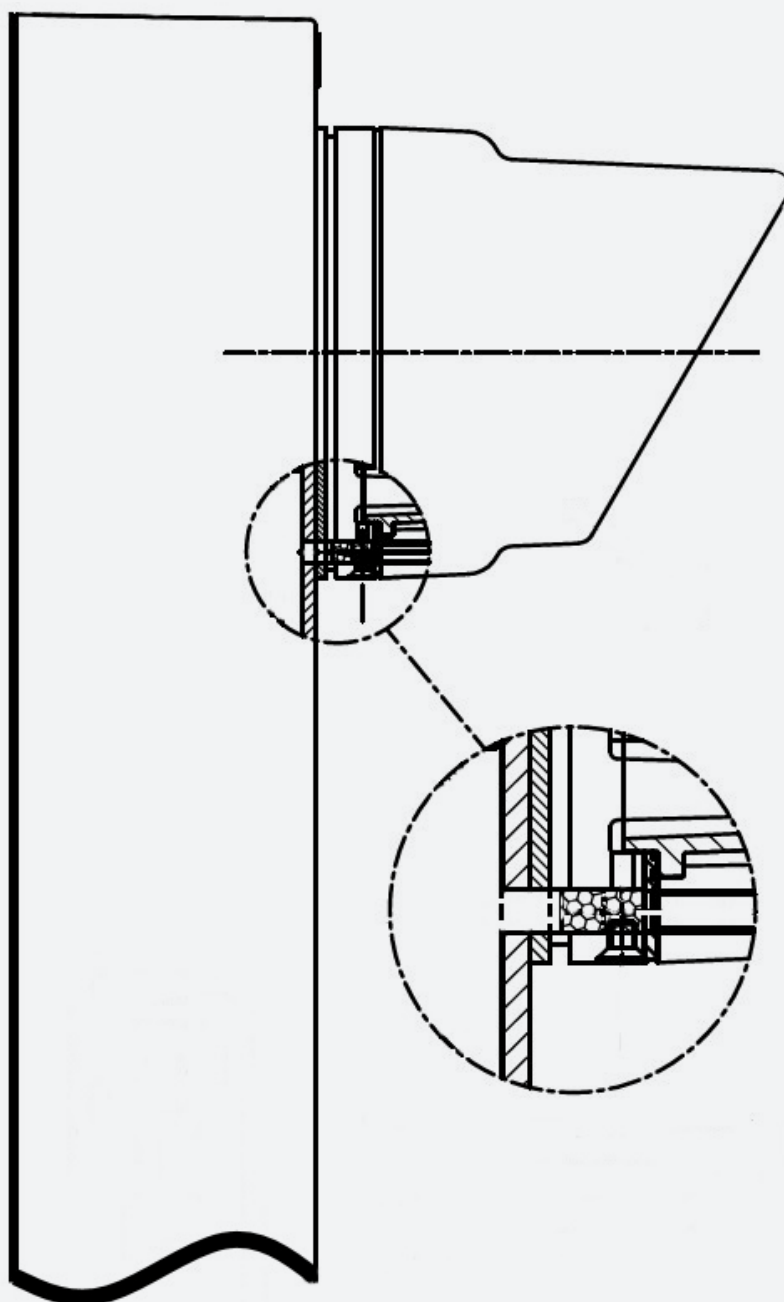

Product Configuration

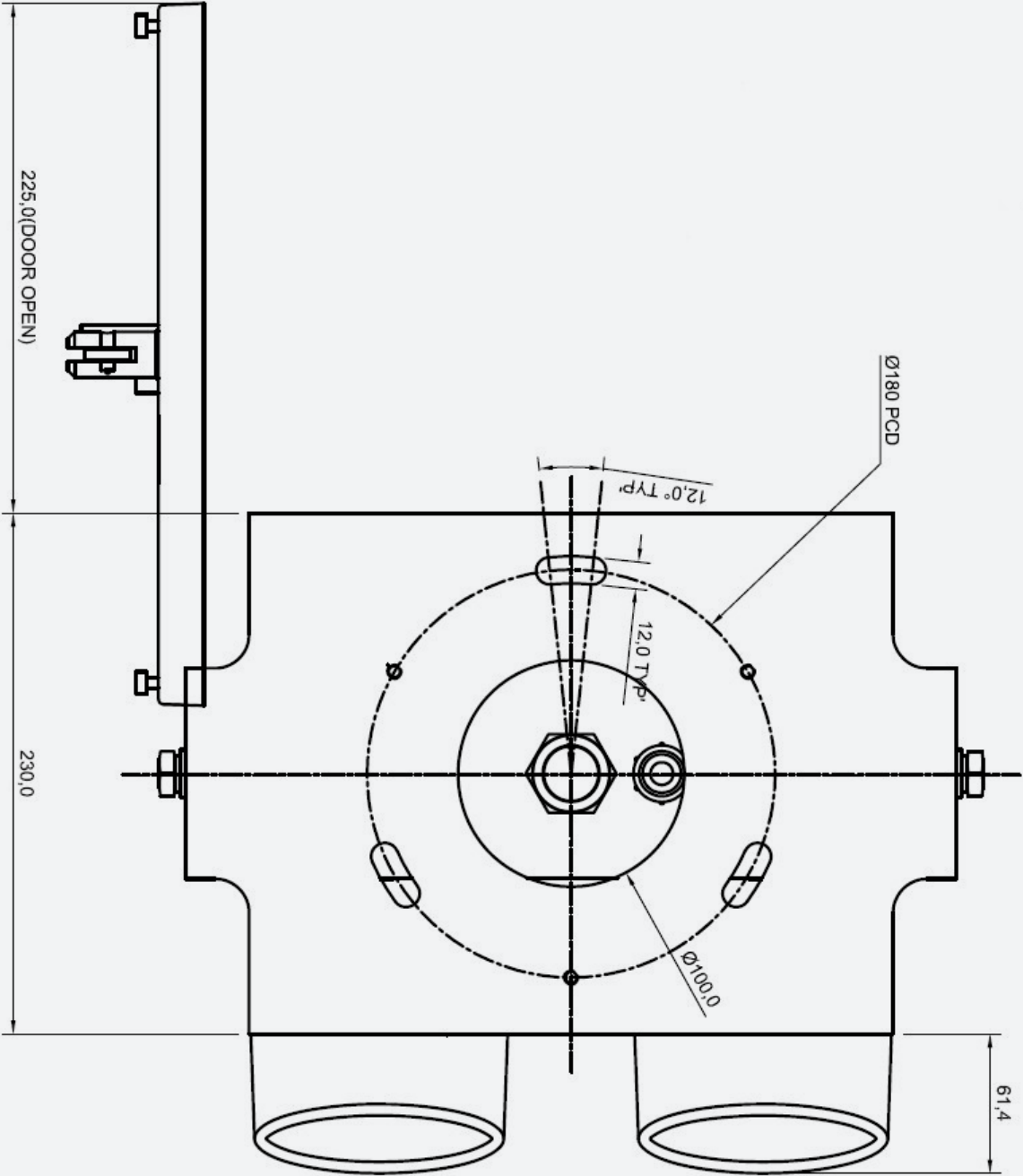

Product Configuration

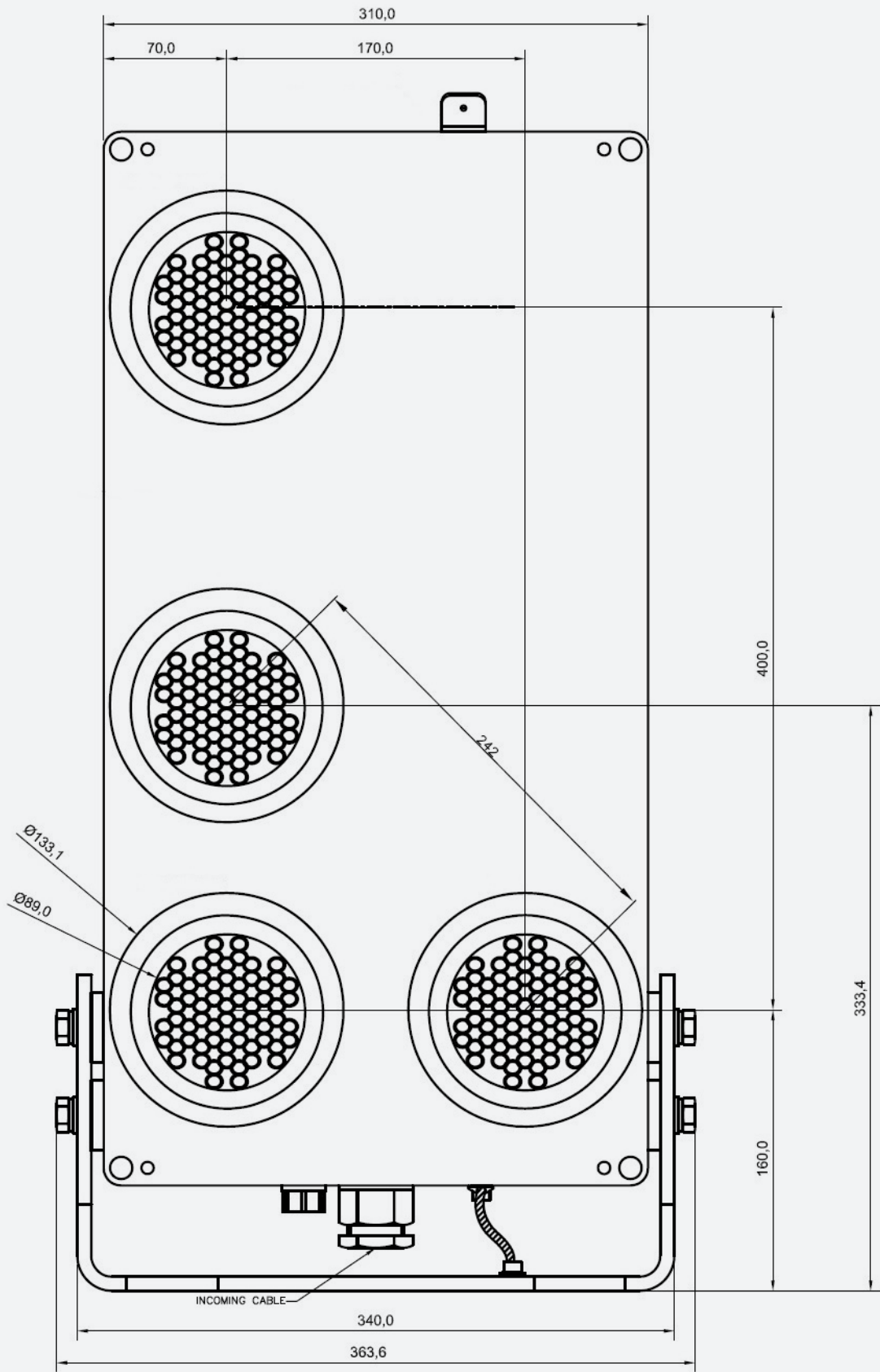

Product Configuration

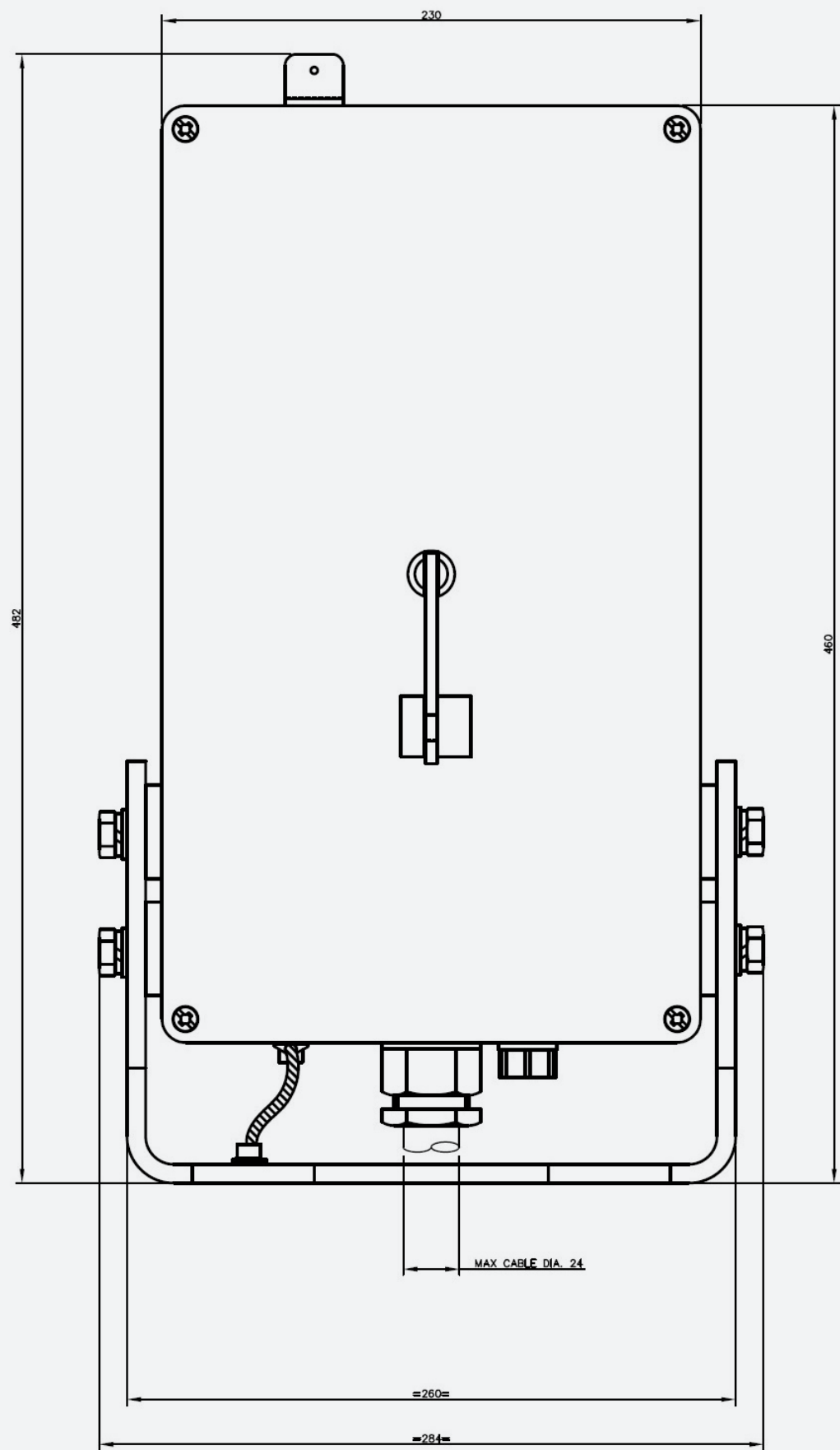

Product Configuration

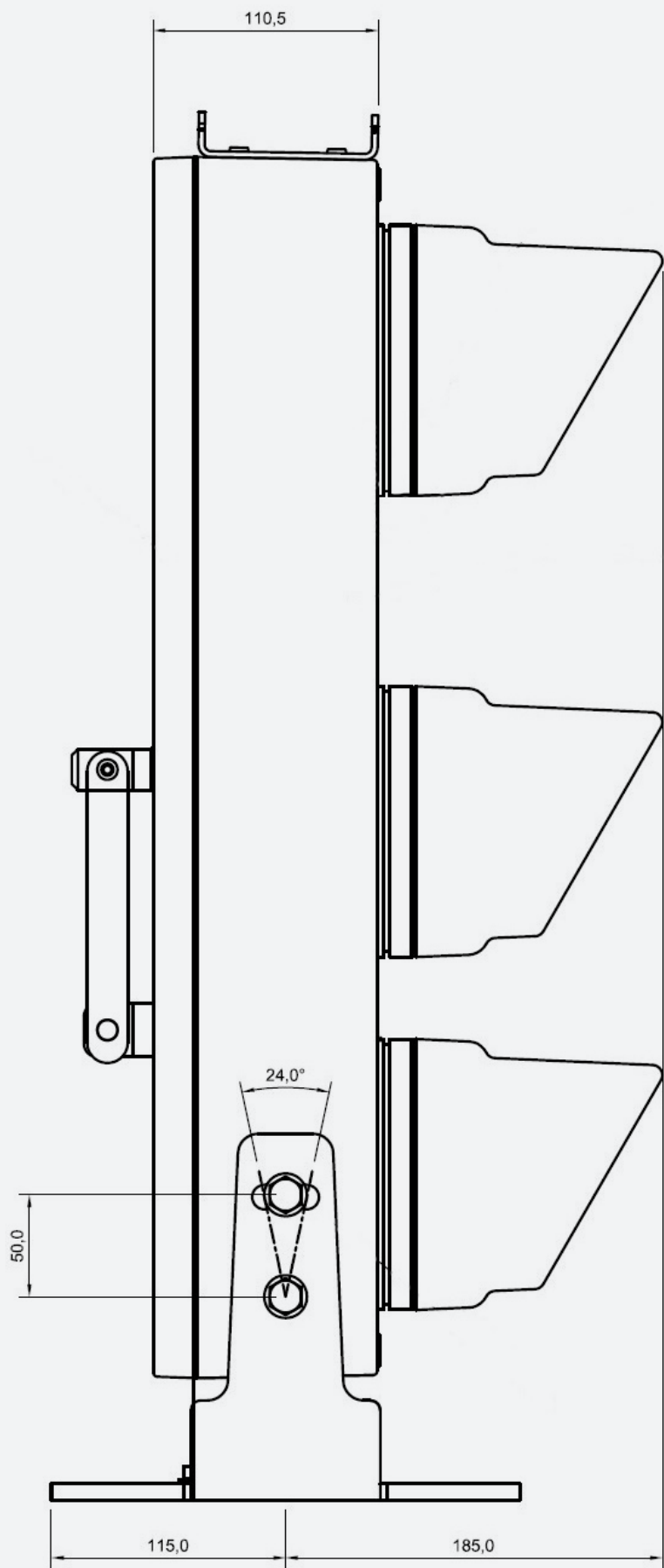

Catalogue Numbers

Signals

Catalogue Number	Unipart Dorman Part Number	Description
0086/077160	M2P/RYGWW/1P/R	RYGY Miniature Tunnel Signal with additional WW PoSA aspect Inverted for Roof Mounting
0086/077161	M2P/RYGWW/1P/G	RYGY Miniature Tunnel Signal with additional WW PoSA aspect for Ground/Wall Mountings
0086/077163	M2P/RYGWW/1P/E	RYGY Miniature Tunnel Signal with additional WW PoSA aspect for Elevated Mounting

The PoSA signal is only available in the configuration RYGWW.

2 and 3 aspect signals will be supplied as a 4 aspect and the unused colours are left disconnected.



Catalogue Numbers

Spare Modules

Catalogue Number	Unipart Dorman Part Number	Description
0086/009237	M2TM2/R/Y/1/P/G	Mk2 Miniature Tunnel Signal Red/Yellow
0086/009238	M2TM2/G-/1/P/G	Mk2 Miniature Tunnel Signal Green
0086/009239	M2TM2/G/Y/1/P/G	Mk2 Miniature Tunnel Signal Green/Yellow
0086/0077162	M2TM2/W-/1/P/G	Mk2 Miniature Tunnel Signal Lunar White

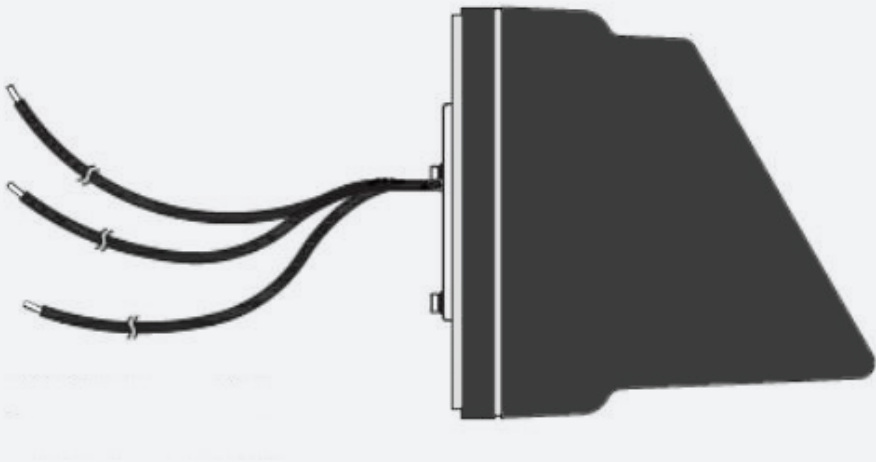

Accessories

Catalogue Number	Unipart Dorman Part Number	Description
0086/009245	B20.19384	Mounting Adaptor Plate. Enables Unipart Dorman LED Miniature PoSA to be used on a Standard Colour Light Signal base (BRS-SE81)
0086/009168	B20.19193	Aperture Blank Plate

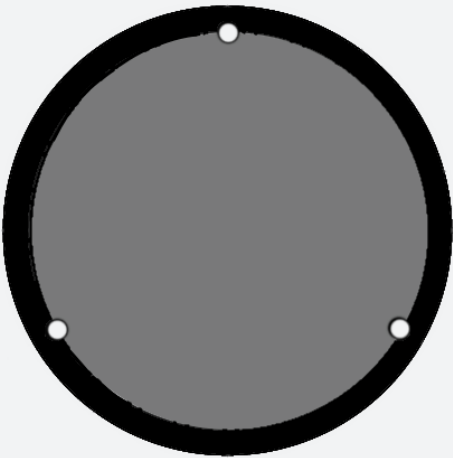
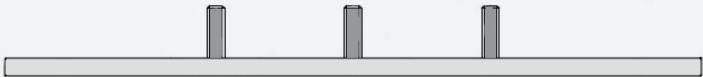
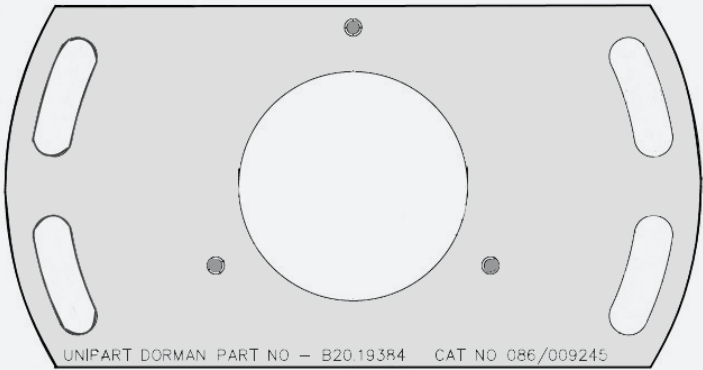

Contact us today to learn
how we can help your
business improve reliability,
efficiency and safety in
railway operations.



Click or scan
to contact us