



Performance in motion



Miniature Tunnel Signal



The Unipart Dorman Miniature Tunnel Signal (MTS) uses a combination of either 1 or 2 single/dual colour Miniature Tunnel Modules (MTM).

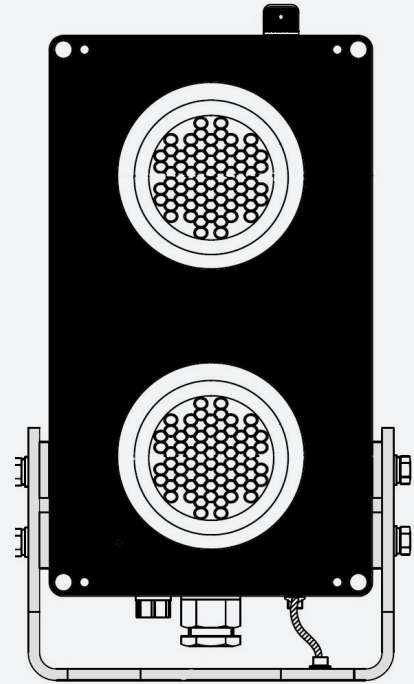

Displaying either Red, Yellow or Green to deliver 1,2,3 and 4 aspect signals and are either ground, elevated or roof mounting. Mk2 MTM are supplied for new signals and these are not interchangeable with either Mk1 MTM or standard SLM. The Product Acceptance states "In the event of a Mk1 Module requiring replacement the complete signal head shall be replaced.

Performance Characteristics

Product Approval Certificate	PA05/02316
Nominal Operating Voltage	110 Vac or 120 Vdc
Operating Voltage Range AC	88-121 V
Operating Voltage Range DC	88-145 V
Nominal Operating Current	300 mA at 110Vac
Electrical Connector Type	Free Wired to 2BA Terminal Bar
Ingress Protection Rating	IP 65
Operating Temperature Range	-25°C to +40°C
Readability	400m in tunnel conditions
Product Weight	1 module head 10Kg 2 module head 12Kg 4 aspect head 13Kg Module only 1.6Kg
For product instructions and dimensioned drawings please visit:	www.unipartdorman.co.uk

Product Configuration

The Miniature Tunnel Signal (MTS) is available in 3 configurations.

Ground Mounted where the Red Aspect is in the top module.

Elevated Mounted where the Red Aspect is in the bottom module.

Roof Mounted where the Red Aspect is in the bottom module and the modules are inverted.

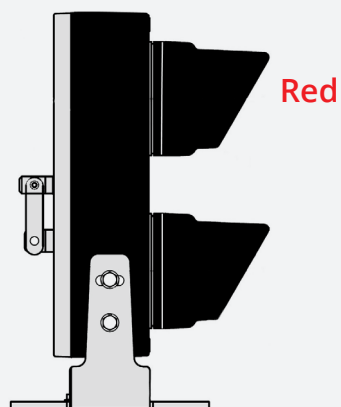

Ground

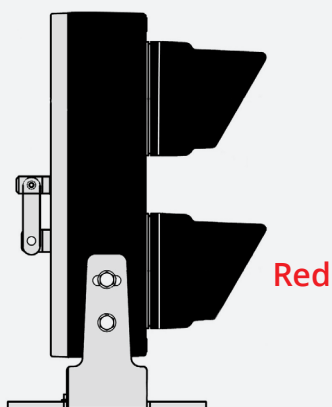

Elevated

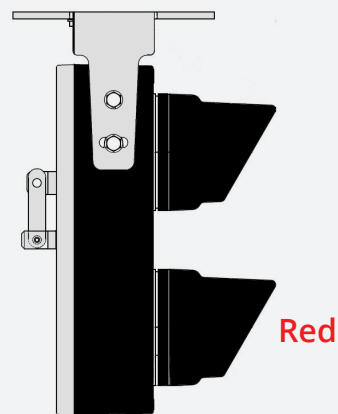

Roof Mounted

Aspect Colours

Dual colour Miniature Tunnel Modules are used and can display Red/Yellow or Green/Yellow which will give the full range of aspects up to and including RYYG.

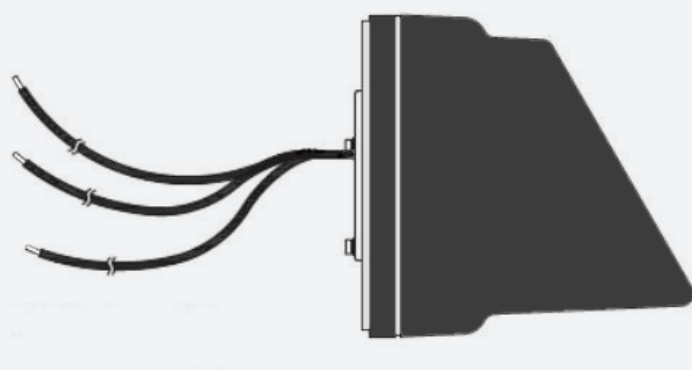

Product Configuration

Following a design improvement exercise, the Miniature Tunnel Module (MTM) was modified to move the breather from the bottom of the module to the back plate and this aligns with a orifice in the redesigned case to remove any moisture ingress to the MTM in the tunnel environment by not venting straight to atmosphere but into the void inside the case.

These modules and signals have been designated as Mk2 signals and are not interchangeable with the Mk1.

The Network Rail Product Acceptance Certificate clearly states "In the event of a Mk1 module requiring replacement, the complete signal head shall be replaced."

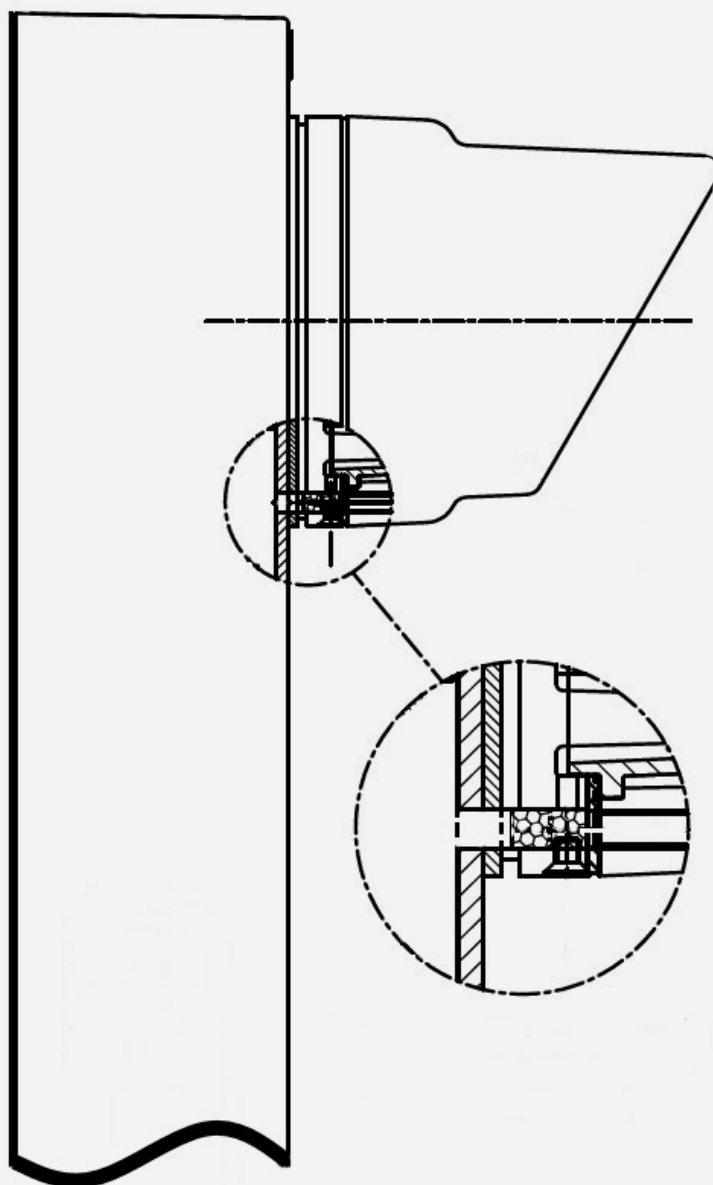

Product Configuration

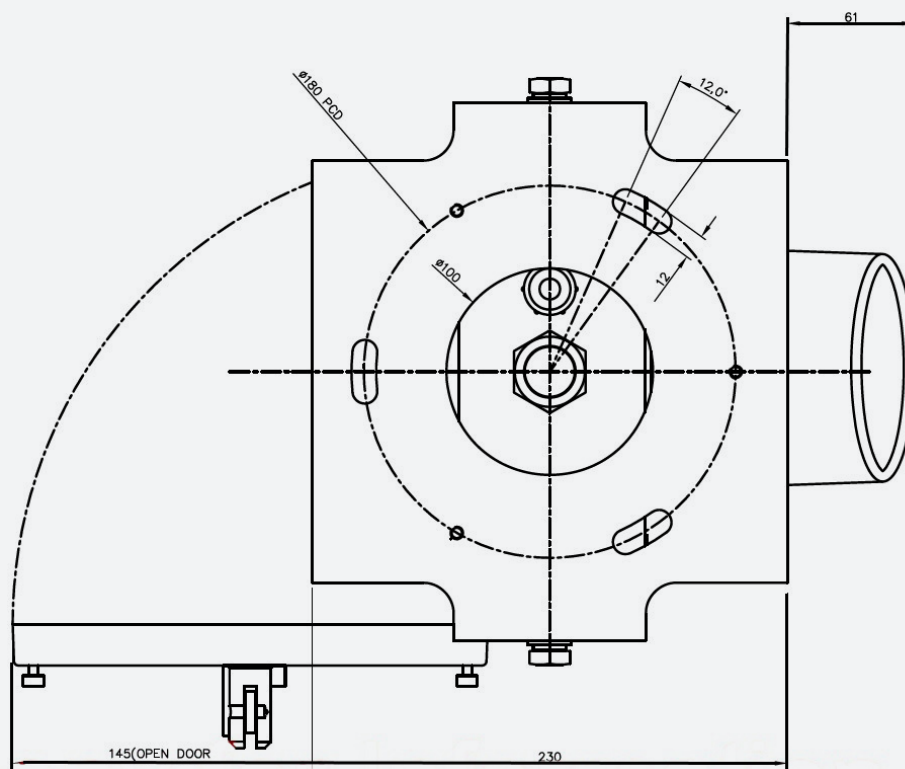

3 stud baseplate common to all variants

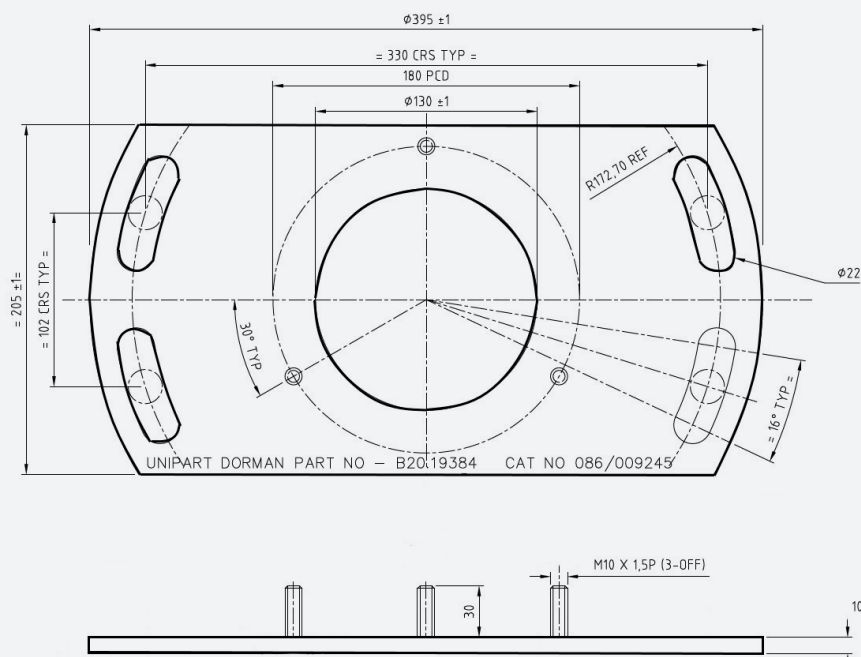

3 stud to 4 hole converter plate

Product Configuration

(1&2 Aspect Heads)

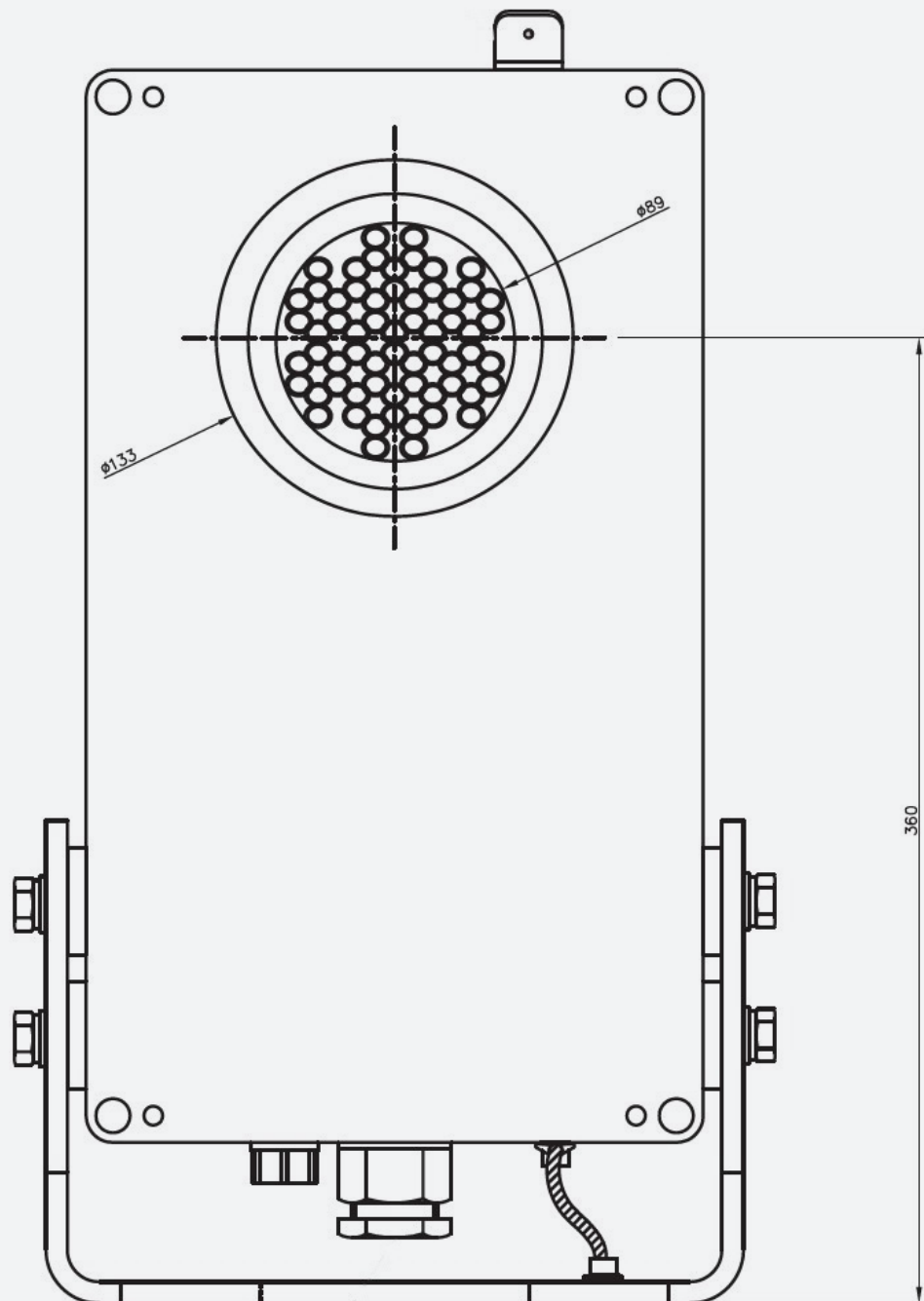

Product Configuration

(1&2 Aspect Heads)

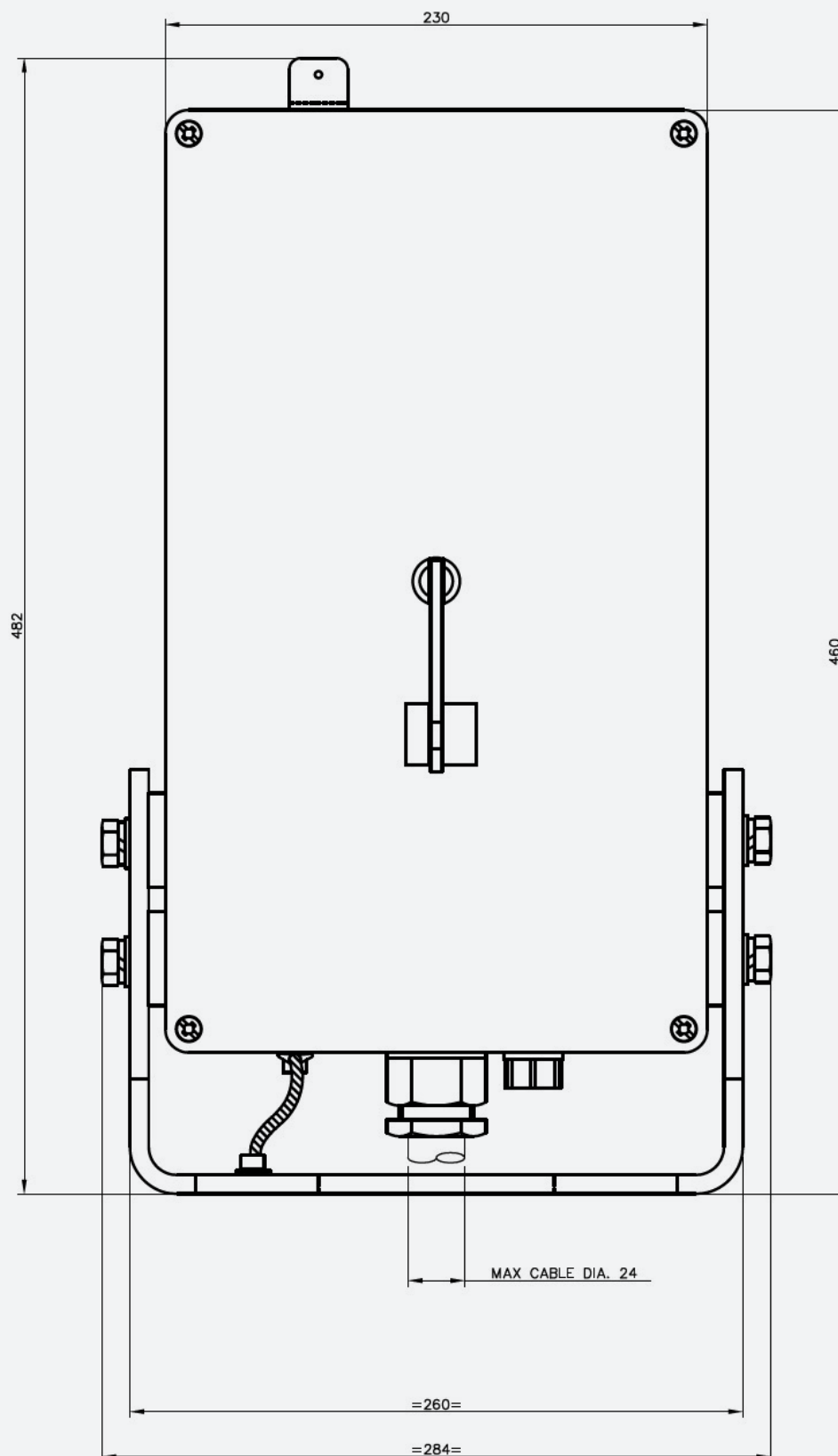

Product Configuration

(1&2 Aspect Heads)

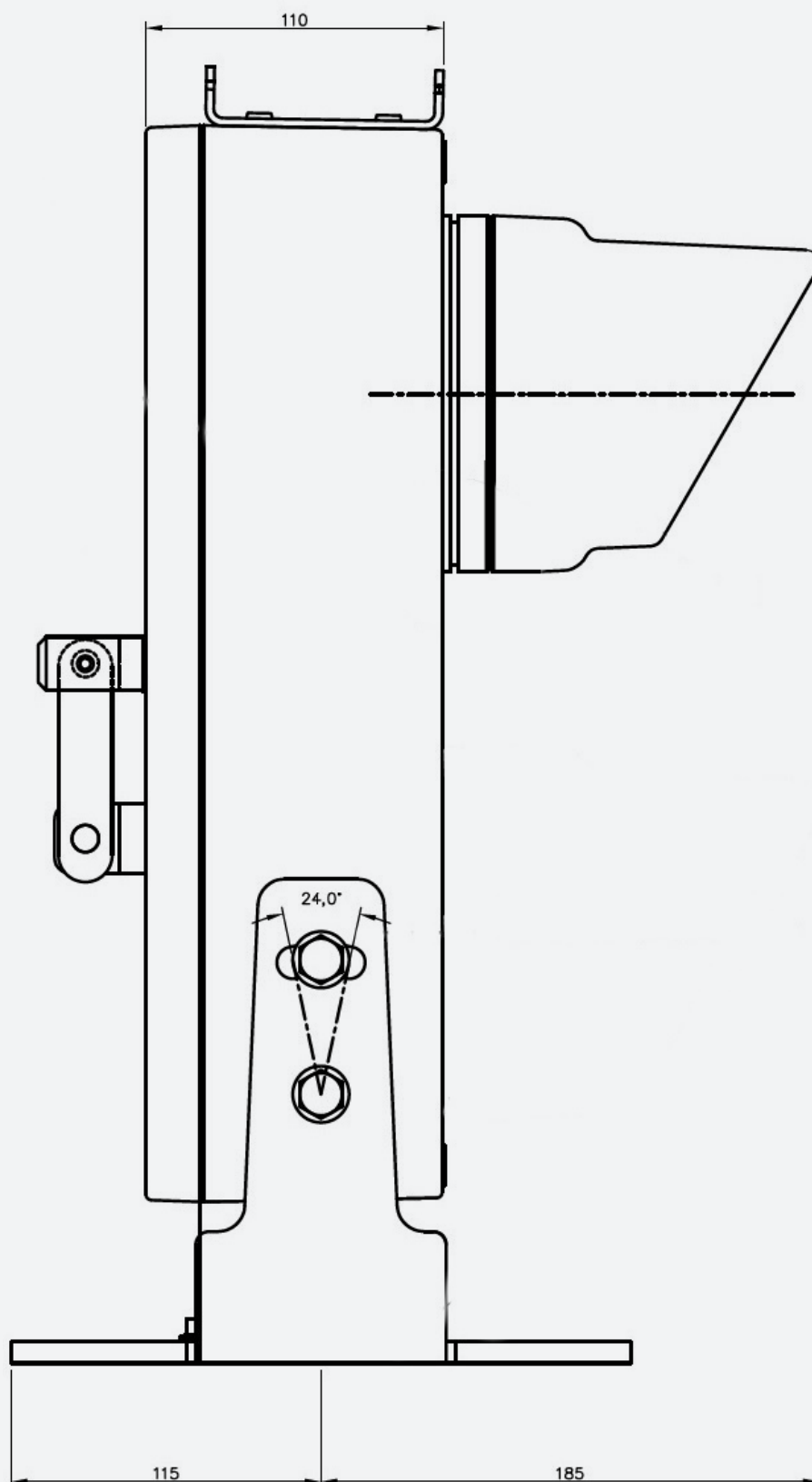

Product Configuration

(3 Aspect Heads)

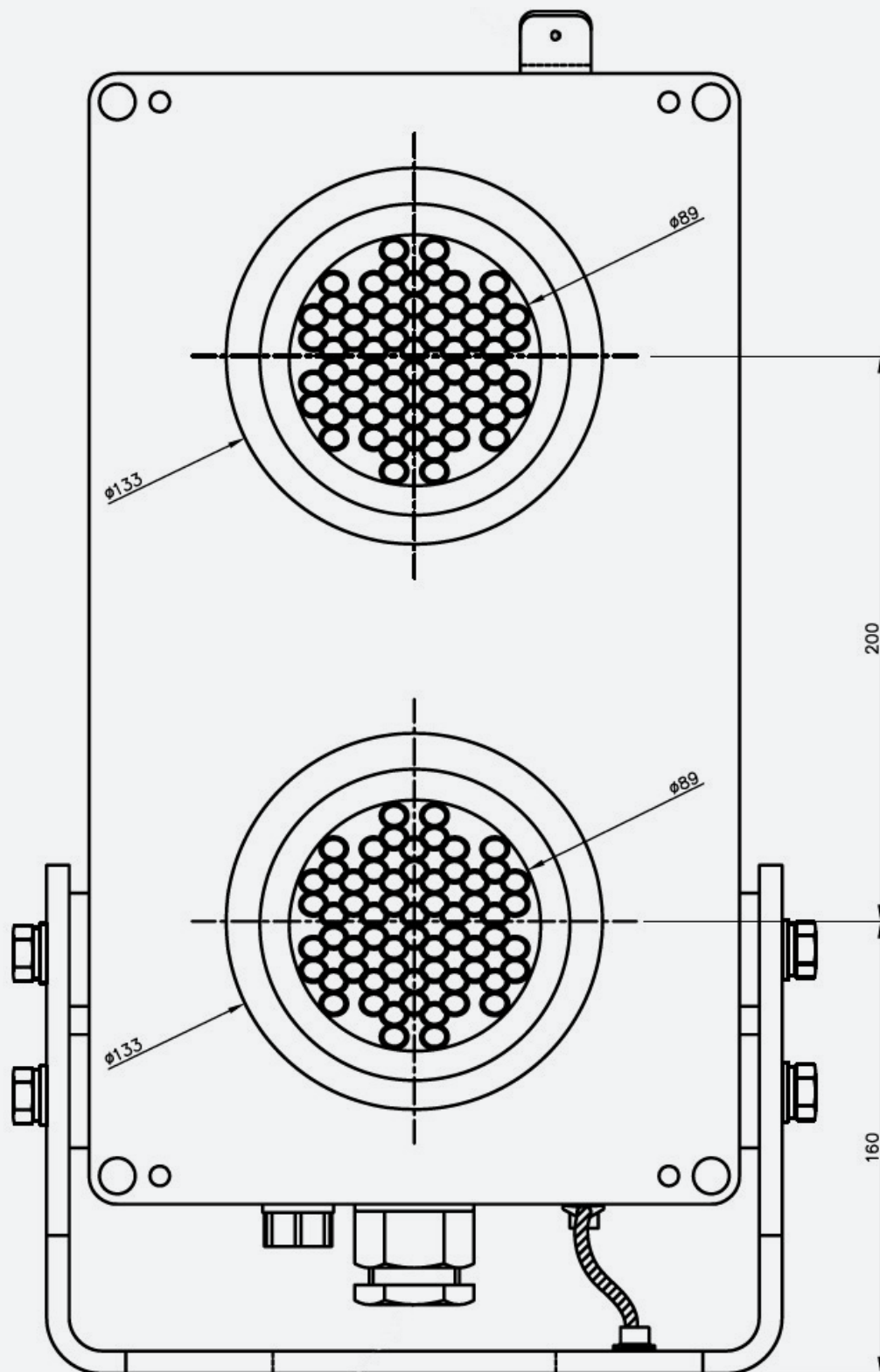

Product Configuration

(3 Aspect Heads)

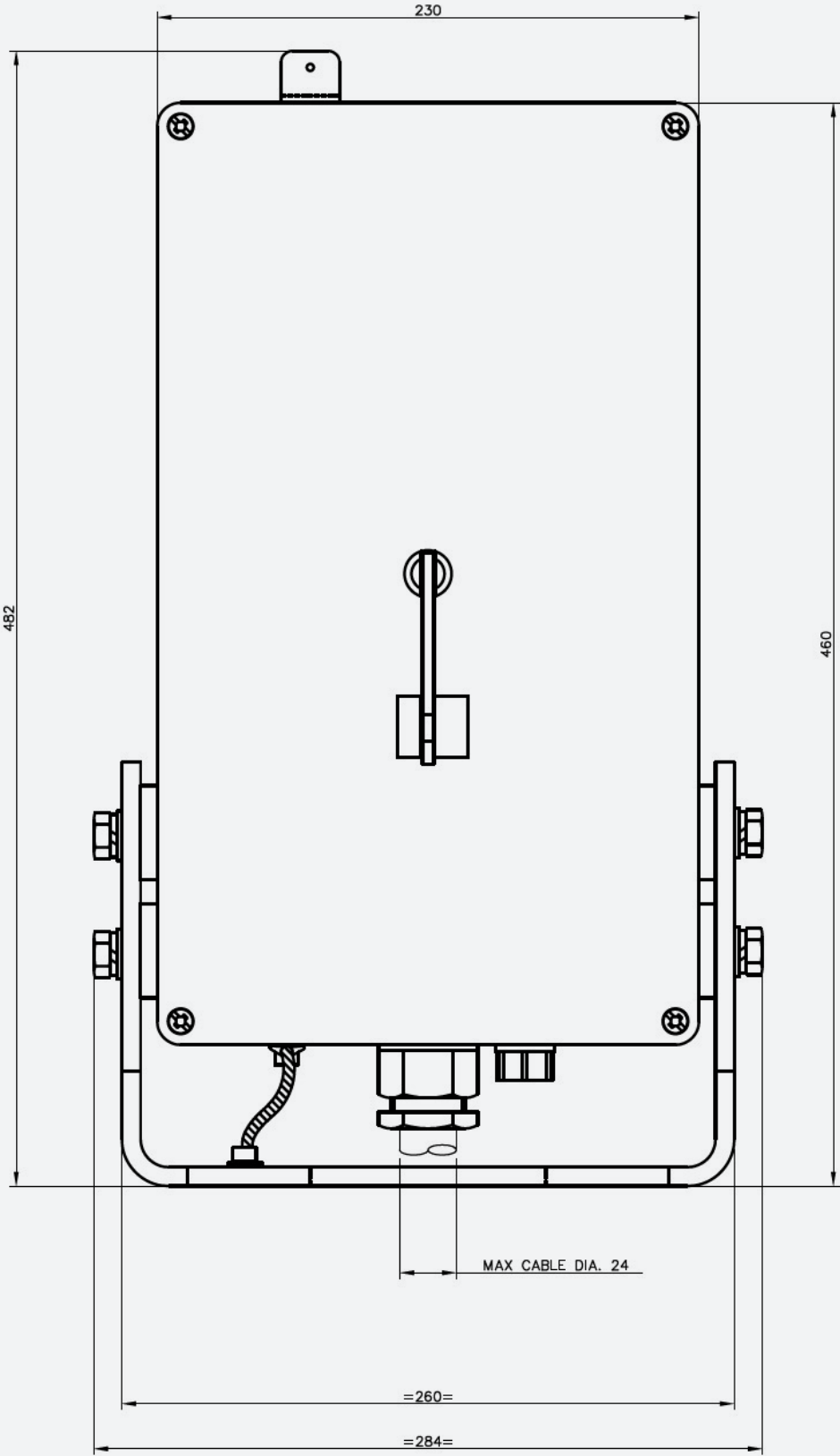

Product Configuration

(3 Aspect Heads)

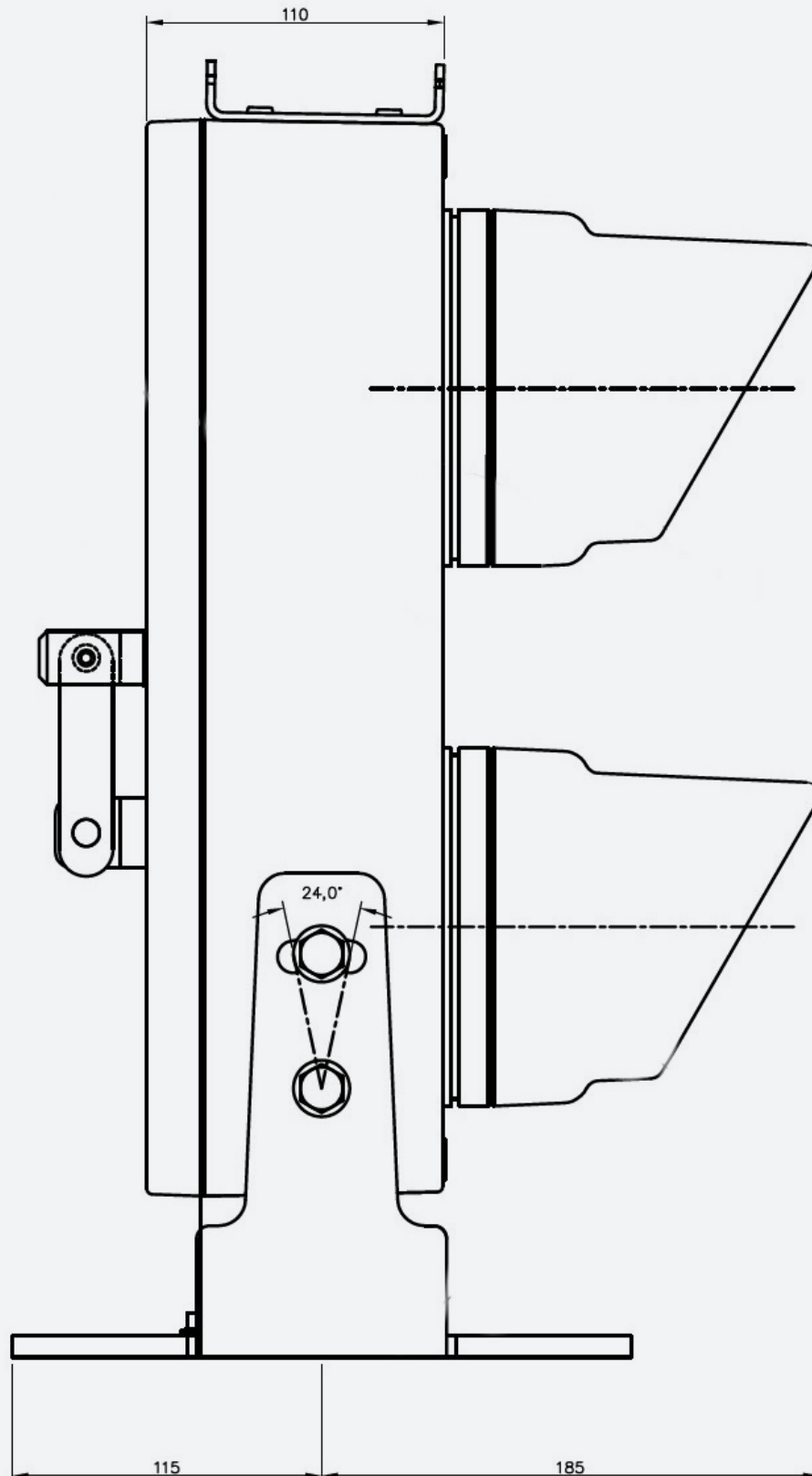

Product Configuration

(4 Aspect Heads)

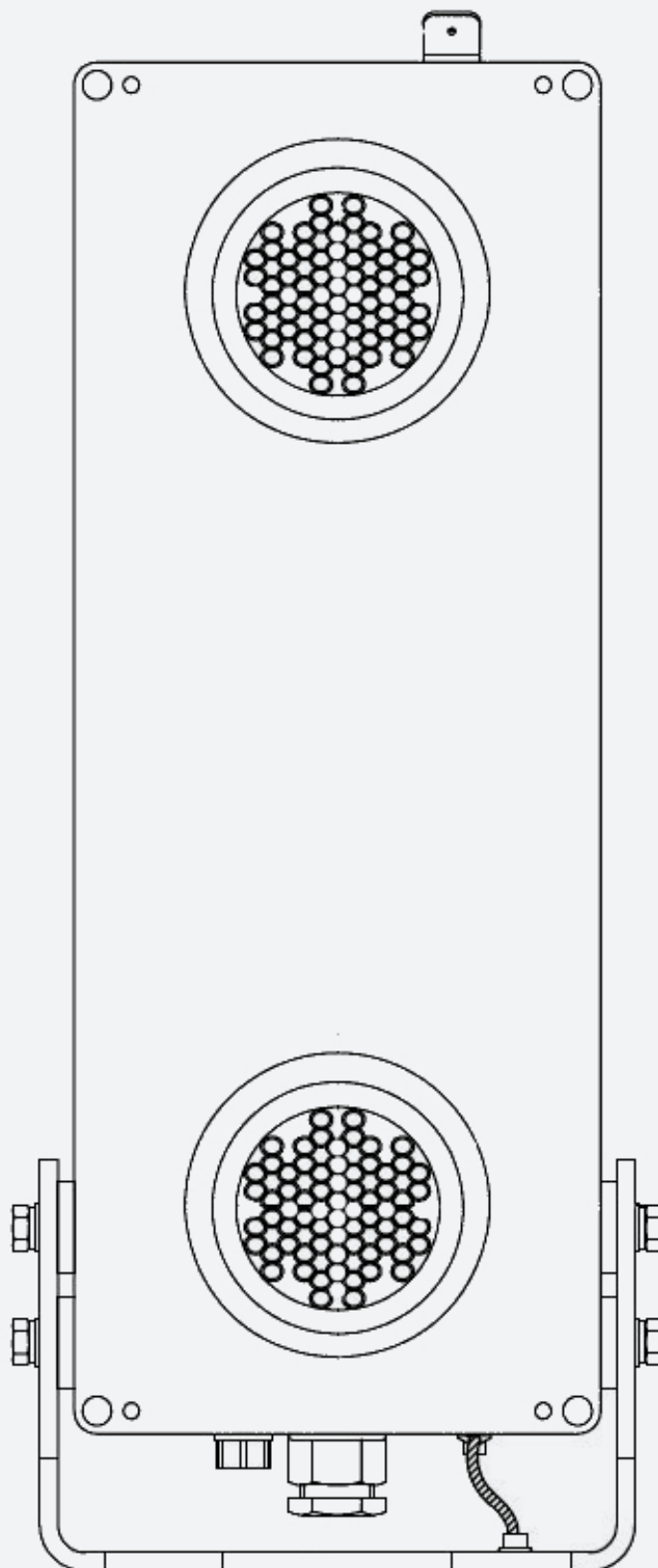

Product Configuration

(4 Aspect Heads)

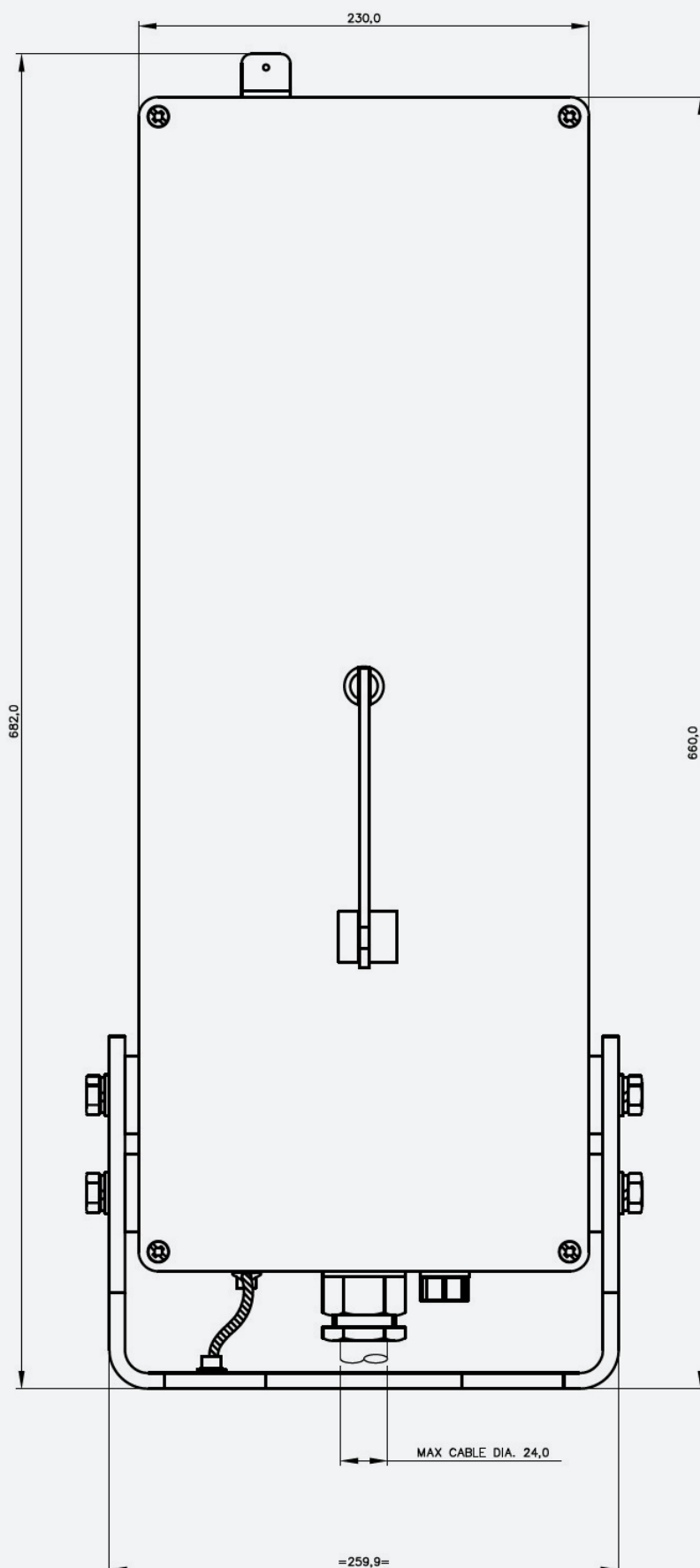

Product Configuration

(4 Aspect Heads)

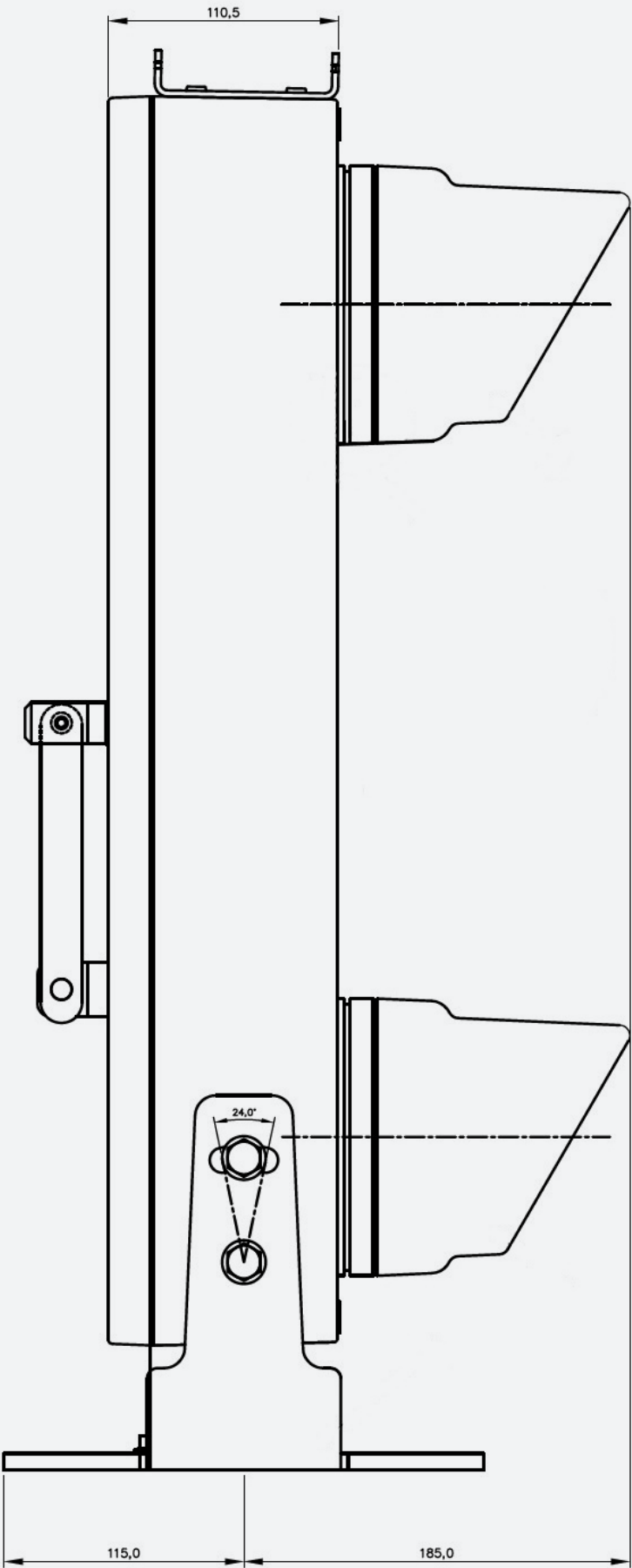

Catalogue Numbers

Ground Signals

Catalogue Number	Unipart Dorman Part Number	Description
0086/009233	M2TSH/2RY-/1P/G	RY Miniature Tunnel Signal for Ground/Wall Mountings
0086/009234	M2TSH/2GY-/1P/G	GY Miniature Tunnel Signal for Ground/Wall Mountings
0086/009235	M2TSH/3RYG/1P/G	RYG Miniature Tunnel Signal for Ground/Wall Mountings
0086/009236	M2TSH/RYG/1P/G	RYGY Miniature Tunnel Signal for Ground/Wall Mountings
0086/009233	M2TSH/2RY-/1P/G	RY Miniature Tunnel Signal for Ground/Wall Mountings
0086/009234	M2TSH/2GY-/1P/G	GY Miniature Tunnel Signal for Ground/Wall Mountings

Elevated Signals

Catalogue Number	Unipart Dorman Part Number	Description
0086/009243	M2TSH/RYG/1P/E	RYGY Miniature Tunnel Signal for Elevated Mounting
0086/009244	M2TSH/3RYG/1P/E	RYG Miniature Tunnel Signal for Elevated Mounting



Catalogue Numbers

Roof Mounted Signals with inverted modules

Catalogue Number	Unipart Dorman Part Number	Description
0086/009229	M2TSH/2RY-/1P/R	RY Miniature Tunnel Signal Inverted for Roof Mounting
0086/009230	M2TSH/2GY-/1P/R	GY Miniature Tunnel Signal Inverted for Roof Mounting
0086/009231	M2TSH/3RYG/1P/R	RYG Miniature Tunnel Signal Inverted for Roof Mounting
0086/009232	M2TSH/RYG/1P/R	RYGY Miniature Tunnel Signal Inverted for Roof Mounting

Spare Modules

Catalogue Number	Unipart Dorman Part Number	Description
0086/009237	M2TM2/R/1/P/G	Miniature Tunnel Signal Module, Red/Yellow
0086/009238	M2TM2/G-/1/P/G	Miniature Tunnel Signal Module, Green
0086/009239	M2TM2/GY/1/P/G	Miniature Tunnel Signal Module, Green/Yellow

Accessories

Catalogue Number	Unipart Dorman Part Number	Description
0086/009245	B20.19384	Mounting Adaptor Plate. Enables Unipart Dorman LED Miniature Tunnel Signal to be used on a Standard Colour Light Signal base (BRS-SE81)
0086/009168	B20.19193	Aperture Blank Plate
TBC	B20.19539	Assisted Lift Trunnion Miniature Tunnel Signal Mounting Kit

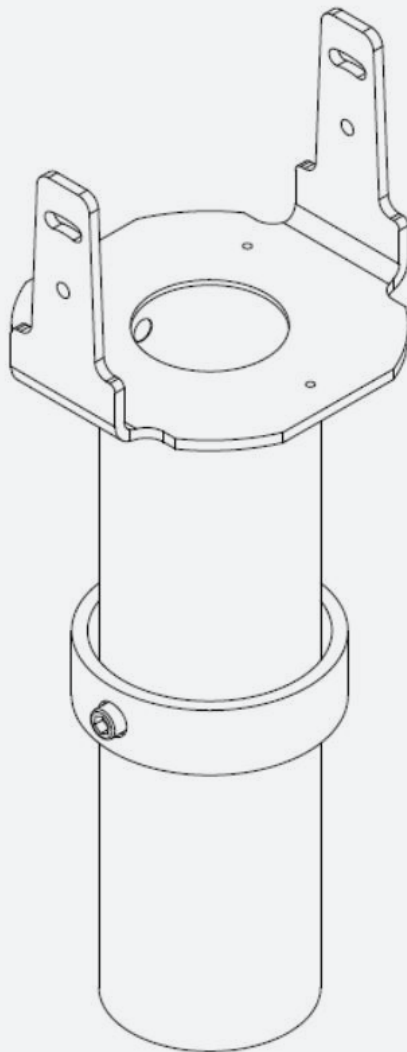
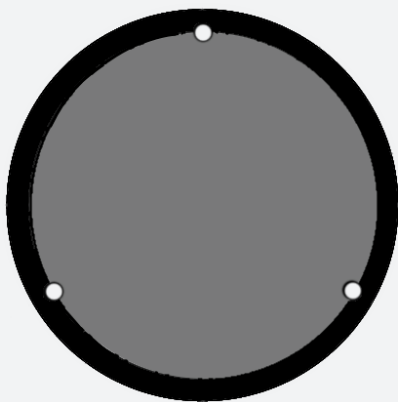
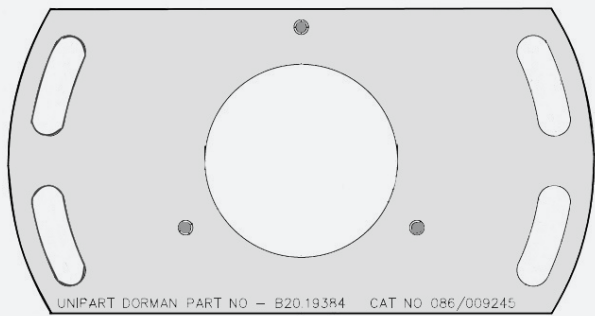

Contact us today to learn how we can help your business improve reliability, efficiency and safety in railway operations.



Click or scan
to contact us